



Schneebeli **Revolving** **Security Doors**

The Schneebeli revolving security door tackles access control from the right angle.

Schneebeli revolving security doors are installed where only authorised personnel are permitted access to a building or a certain part of a building, e.g. staff entrance. Together with a freely selected access control system, this type of door ensures that no undesired visitors can gain admittance. Nevertheless, the revolving security door provides a relatively high passage rate of approx. 500 to 1'000 people per hour, depending on the version.

Schneebeli revolving security doors are available in three basic versions (90, 120 and 180) that beautifully combine security with aesthetics.

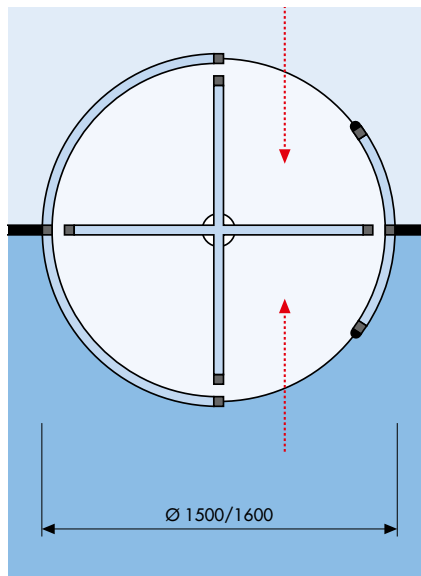
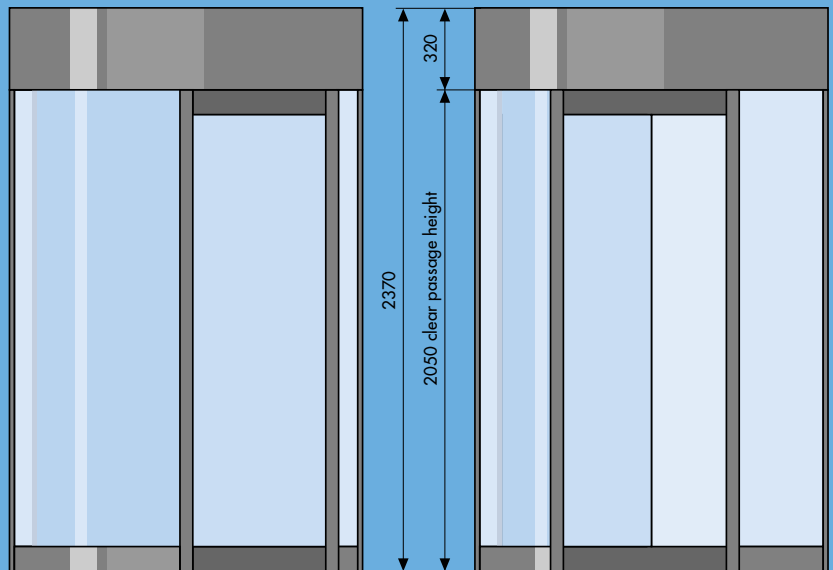

Revolving security door type 90

The revolving security door (SDT) type 90 from Schneebeli is an access control entrance with an excellent security and very high throughput capacity of approx. 500 people per hour in one direction. The revolving door cylinder consists of a semi-circle and a quarter circle, and the entrance opening to the left or right can be selected. A security device prevents another person passing through the door simultaneously from the other side.

It is clear and easy to use, however, the space for passing through is a little narrower than with the 120 model. The passage is completed once the rotator has revolved 90°.

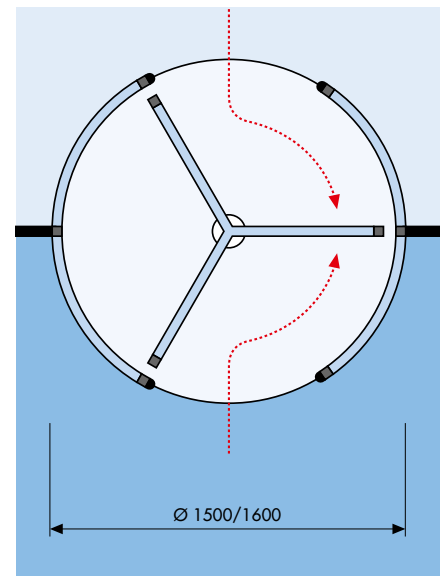

Revolving security door type 120

The revolving security door (SDT) type 120 from Schneebeli is an access control entrance with an excellent security and very high throughput capacity of approx. 500 people per hour in one direction. The revolving door cylinder has two 120° arcs with the entrance opening in the middle. A security device prevents another person passing through the door simultaneously from the other side.

The space for passing through is even more comfortable than with the 90 model. The passage is completed after a 120°-revolution.

Aesthetics and security are beautifully combined in the Schneebeli revolving security doors.

General construction:

All revolving security doors consist of a 2-part cylinder jacket made from a tubular steel framework with glass or metal cladding.

The electromechanical drive is installed in the round roof structure.

Depending on the model, the rotating rotor consists of 3 or 4 glass door leaves without a central column. The revolving security door can be positioned on the finished floor or on a base frame. Model 180 requires a base frame or a sill because of the floor contact mat.

The glazing is made from burglar-resistant laminated safety glass.

General function:

The door is released by a pulse input from the building's on-site access control system. The revolving door rotates, powered by the drive, as soon as a person enters the door or after it has been triggered. After it has finished revolving, the door locks again.

Exiting the building follows the same process in the reverse direction.

Entry to and exit from the building can also be enabled by remote control. Likewise, the revolving door can be locked again as required at any time by remote control, even as it is revolving.

If there is a power cut, the door is locked again on both sides after the passage that was started is completed.

For cleaning purposes, the revolving door can be freely switched with a special switch.

Technical data:

Surface treatment:

- Stove enamelled steel
- Matt or polished stainless steel
- Burnished brass

Power supply 230 V / 50 Hz, 13 A

Wattage 0.5 kW

SPS control system installed in the control cabinet or soffit.

Electrical cables from above or below.

Lighting in the revolving door on request (LED lights).

The revolving security doors can be connected to any access control system.

Subject to dimensional and technical changes in design.

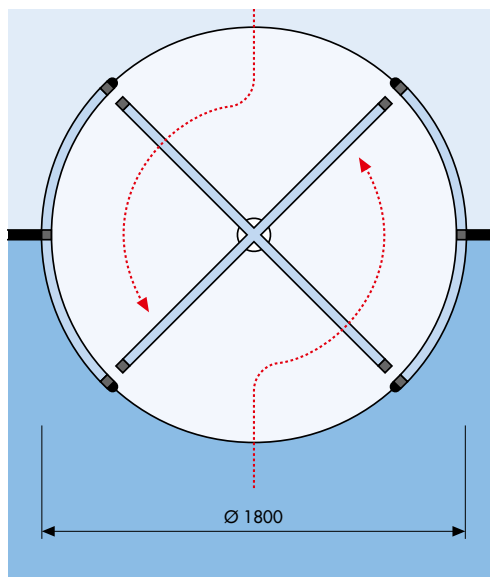
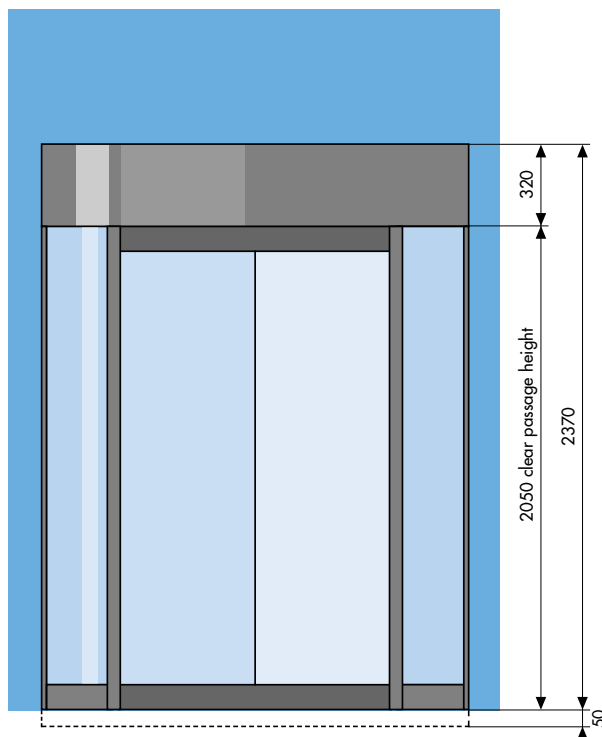

Revolving security door type 180

The revolving security door (SDT) type 180 from Schneebeli is an access control entrance with an excellent control function and very high throughput capacity of approx. 1'000 people per hour simultaneously in both directions. The rotating door cylinder consists of two quarter-circle arcs and the entrance opening in the middle. It looks similar to a carousel revolving door.

It is easy to use as the person walking through must always keep to the right as with a normal revolving door. The revolving door can also be entered at the same time from the opposite direction. If somebody without authorisation enters the door as it is revolving, the door will stop and rotate the other way, so that the unauthorised individual is literally "ejected". If there is an authorised person going through in the opposite direction, they are "ejected" as well, but they can continue on through once the unauthorised individual has vacated the revolving door.

Since the diameter of this revolving door is very wide, it is very manageable and comfortable to pass through. This revolving door cannot therefore guarantee that people will pass through separately, so, as a rule, it is only used as a control entrance. The passage is completed once the rotator has revolved 180°.

This revolving security door can also be built with a smaller diameter of Ø 1600mm as a minimum.

The Schneebeli revolving security door is a flexible system with numerous extension options.

Burglar-resistant Revolving security doors RC2

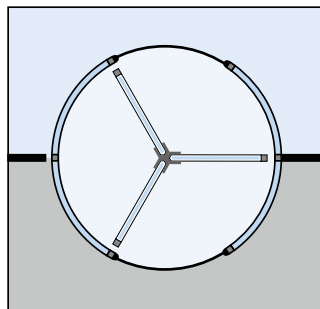

The size of this burglar-resistant variant of the revolving security door corresponds to that of the normal revolving security door. Even its elegant look is almost identical. The side walls, the rotor and the roof area are reinforced structures. The glazing of the curved side walls and rotor are made from laminated safety glass. The glass edges in the centrepoint of the rotor are protected with sheets of stainless steel. The function is the same as with the normal revolving security doors. The same options as with the normal revolving security doors are also possible for the surface finish. The walls and components must be of the corresponding strength for the installation and fastening of the revolving security doors. All 3 models in burglar-resistant class RC2 can be installed:

- SDT type 90-RC2
- SDT type 120-RC2
- SDT type 180-RC2

This revolving security door has been tested by the Institut ift Rosenheim and received the classification of RC2.

Burglar-resistant Revolving security doors RC3

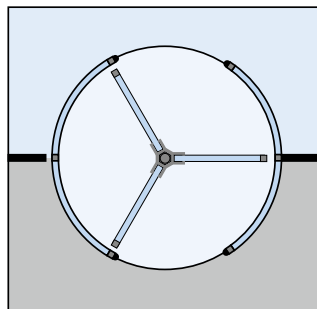

The size of this burglar-resistant variant of the revolving security door corresponds to that of the normal revolving security door. Despite its reinforced construction and the slim central column in the rotor, it still looks just as elegant as the normal revolving security door. The glazing of the curved side walls and rotor are made from laminated safety glass. The function is the same as with the normal revolving security doors. The same options as with the normal revolving security doors are also possible for the surface finish. The walls and components must be of the corresponding strength for the installation and fastening of the revolving security doors. All 3 models in burglar-resistant class RC3 can be installed:

- SDT type 90-RC3
- SDT type 120-RC3
- SDT type 180-RC3

This revolving security door has been tested by the Institut ift Rosenheim and received the classification of RC3.

Floor drive

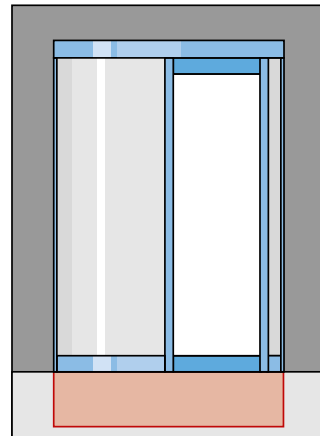

In special cases, the drive can be installed in the floor or the ceiling of the storey below, instead of in the roof area. If it is installed in the floor, there needs to be an extra depth of around 450 mm. Furthermore, if the drive is installed in the floor it is at risk of getting dirty, especially when the floor is cleaned with water. The soffits of revolving doors with floor-mounted drives can be reduced to a height of approx. 100 mm.

Transport or escape doors

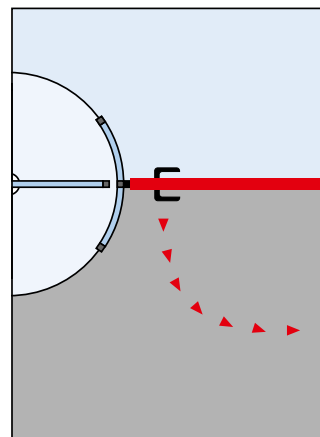

There needs to be a transport or escape door next to the revolving security door if there are no other means for transport or escape. As a rule, it is built in one of the styles to suit the revolving door: stove enamelled steel, matt or polished stainless steel. It can be fitted with all the possible fittings, such as multi-point lock, panic lock, magnetic monitoring from the door leaf, monitoring of the locking contacts and much more.



1



2



3



4



5



6

1 2 revolving security doors, type 120, with side emergency door, in matt polished stainless steel as an elegant entrance for personnel.

2 Revolving security door, type 180, with side emergency door, as an elegant entrance for personnel.

3 2 revolving security doors, type 180, with side emergency door, in stove enamelled steel as an entrance for personnel with very high throughput capacity.

4 Revolving security door, type 90, with floor-mounted drive, in stove enamelled steel.

5 3 revolving security doors, type 90 in matt polished stainless steel as an elegant entrance for personnel in an administration building.

6 2 revolving security doors, type 90 in polished stainless steel as an entrance to an exchange building.

Title page

2 revolving security doors, type 90 with cylinder jacket made of matt polished stainless steel to create a beautiful entrance for staff in an insurance building.



Other specialities from our range of security systems:

Double turnstile as security entrance to a car park in an administration building.



RENO interlocking security door as an external closure and staff entrance of a bank.



Circular booth as a night time entrance to an administrative building beside the main entrance.



The versatile manufacturing programme from our modern workshops in Dietlikon includes:

- Security systems such as mantraps and revolving security doors
- Security doors (burglar resistant)
- Security doors for containment and measures (cell doors)
- Fire doors
- Metal windows
- Display window systems
- House and shop entrances
- Sliding doors, lift-up shutter doors
- Metal staircases
- Special railings in all metals or glass
- Special constructions in all metals
- Bullet-resistant windows, doors and wall panels "Sälzer System" (FB1-FB7)
- Repairs, servicing and maintenance work



Schneebeli

Metallbau + Sicherheitstechnik

Schneebeli Metallbau AG
 Industriestrasse 7
 CH-8305 Dietlikon
 Telefon +41 44 805 60 10
 Telefax +41 44 805 60 11
 info@schneebeli.com
 www.schneebeli.com

Schneebeli Sicherheitstechnik GmbH
 Mitteralmweg 2
 D-83026 Rosenheim
 Telefon +49 8031 807 221
 Telefax +49 8031 807 223